

WIRELESS PEEPHOLE VIDEO DOORBELL

This smart battery Wifi
Video Doorbell lets you
answer the door from
anywhere, whether you're
halfway across the world,
or just too busy to walk to
the door. It lets you see,
hear and speak to visitors
with ease using your smart
phone or tablet.



iPhone

Android

USER MANUAL

Please make full charge before use it!

INSTALL APP



NOTE: Search for **Smart Life**
on the Google Play/iPhone app stores.

STEP 1 CREATE ACCOUNT

Open the app. Follow the
prompts and tap
"Sign Up" to create an
account. Be sure to allow
all permissions requested
by the app.

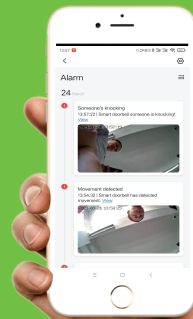

Note: If any security apps have been installed in
your phone/tablet that could affect the
Smart Life app, please be sure to
grant it the appropriate permissions.
please make sure your phone/tablet is connected
to your wifi router (only support 2.4g)

STEP 2 ADD DEVICE

Tap the **+** to add
a new device.

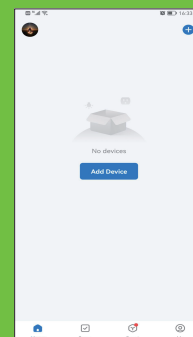

STEP 3

Tap the QR Code to add a new device.
Note: Make sure your
phone/tablet is connected to your
wi-fi internet prior to configuring
the wi-fi for the machine

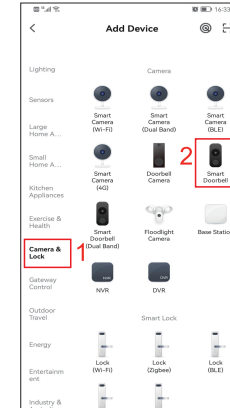

STEP 4

Hold down the button of on screen
for 5 seconds to initiate wi-fi
configuration mode,
once you hear
the voice prompt, tap
"Next."
(please make sure the router
within 2 meters)

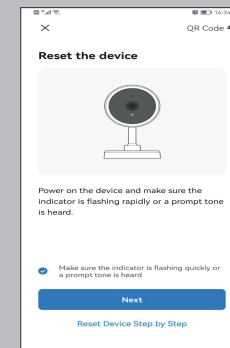

STEP 5

Input your WIFI password
for WIFI configuration
TIP:
WI-FI SET UP
NOT WORKING
Try restarting
your router.

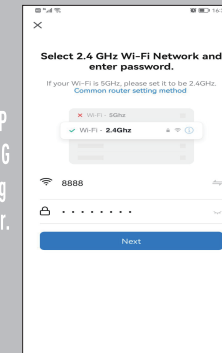

STEP 6

Put your cellphone in
front of the device about
10-20cm to facilitate
QR scanning.

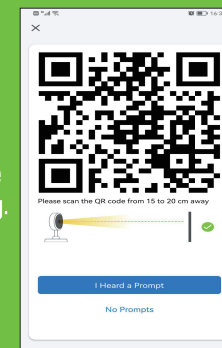

STEP 7 APP/DEVICE CONNECT

Once the Wi-Fi set up is complete and
you hear the voice prompt confirming
that the Wi-Fi configuration was
successful, tap "COMPLETE"

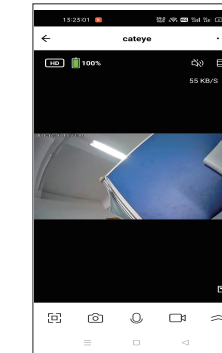
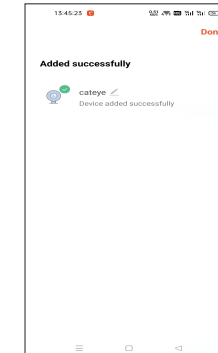

DONE!

DEVICE INSTALLATION

Simply press the
doorbell button to start.



FLIP OVER
FOR MORE
DETAILS!

AUTOMATICALLY WAKES UP

Tap the picture Quick access via app within 3 seconds.

REMOTE VIEWING NOTIFICATIONS

When the doorbell button is pressed, the app will send the following notifications, depending on the mode it's on.

APP INTERFACE FUNCTIONALITY

TAP TO TAKE A SNAPSHOT

TAP AND HOLD DOWN TO TALK

TAP TO RECORD VIDEO

BATTERY LIFE

Quick Settings

PIR SETTINGS

DEVICE APP FUNCTIONS

After installing the app, go into your device's information by tapping on the added device. Here you may review your pictures, videos, change your Wi-Fi settings, share the device or delete the device.

SHARING WITH OTHER PHONES

Shared users: Please download and install the app before proceeding.

This device can support 4 users. The shared users can add the device by scanning the shared QR Code provided by the Administrator (owner of device).

Setp 1: Choose the device you want to share.

Setp 2: Click "Setting", choose share device.

Setp 3: Click "Add Sharing"

Setp 4: Enter the account you want to share in the account field.

Setp 5: When the input is complete, click "Done" in the upper right corner. Complete sharing!

MOUNTING WALL INSTALLATION

Kind tips:
1. Do not pull the cable too hard during installation
2. The cable contains data transmission, please do not fold it

PARTS & SPECS

STANDBY MODE

Android will receive a phone call.

iPhone will receive a push notification. Tap to continue.

This function can only be enabled AFTER the app has been successfully added to your phone.

When pir alarm (PIR) are turned on, you'll be notified on your phone whenever motion is detected or when theft is attempted.

PLAYBACK

Click "Playback" to check the SD card storage record

*The device only support above Class 10 FAT32 TF cards.

TROUBLE SHOOTING

WONT TURN ON: Please ensure that the device is properly charged.

DEVICE WONT TURN ON AFTER INITIAL USE: If you remove the device from the mounting plate while the Tamper Alarm function is turned on, you may disable the device. Simply put it back on the mounting plate and press the doorbell button. GO to the app settings to turn off the Tamper Alarm.

DEVICE WONT TURN ON AFTER INITIAL USE: If prompted with "The Connection Failed, Please Check The Wi-Fi Configuration is Correct" when ringing the doorbell after the device has been successfully configured, there may be too many barriers (typically walls) between your Wi-Fi router and the device which has weakened the signal.

TROUBLE SHOOTING

WONT TURN ON: Please ensure that the device is properly charged.

DEVICE WONT TURN ON AFTER INITIAL USE: If you remove the device from the mounting plate while the Tamper Alarm function is turned on, you may disable the device. Simply put it back on the mounting plate and press the doorbell button. GO to the app settings to turn off the Tamper Alarm.

DEVICE WONT TURN ON AFTER INITIAL USE: If prompted with "The Connection Failed, Please Check The Wi-Fi Configuration is Correct" when ringing the doorbell after the device has been successfully configured, there may be too many barriers (typically walls) between your Wi-Fi router and the device which has weakened the signal.

SPECIFICATION:

MATERIAL: Aluminum Alloy

LCD SIZE: 4.3 Inch

DISPLAY RESOLUTION: 1080P

BY PHONE: Android, iOS

ANGLE OF VIEW: 120°

MOTION DETECTION: Support PIR

WI-FI MODE: 802.11 b/g/n

INPUT/OUTPUT: Built-in microphone, two-way audio

NIGHT VISIBILITY: with IR Led, Night vision up 1-3 meters

STORAGE: Cloud storage and TF Card (128G Max.)

BATTERY: 5000mAh battery, charged by USB (5V, 1A)

USER ACCOUNTS: Total 4 Users (Admin user and shared user)

CERTIFICATION: CE, FCC, RoHS